

# Retail - Floor Plan

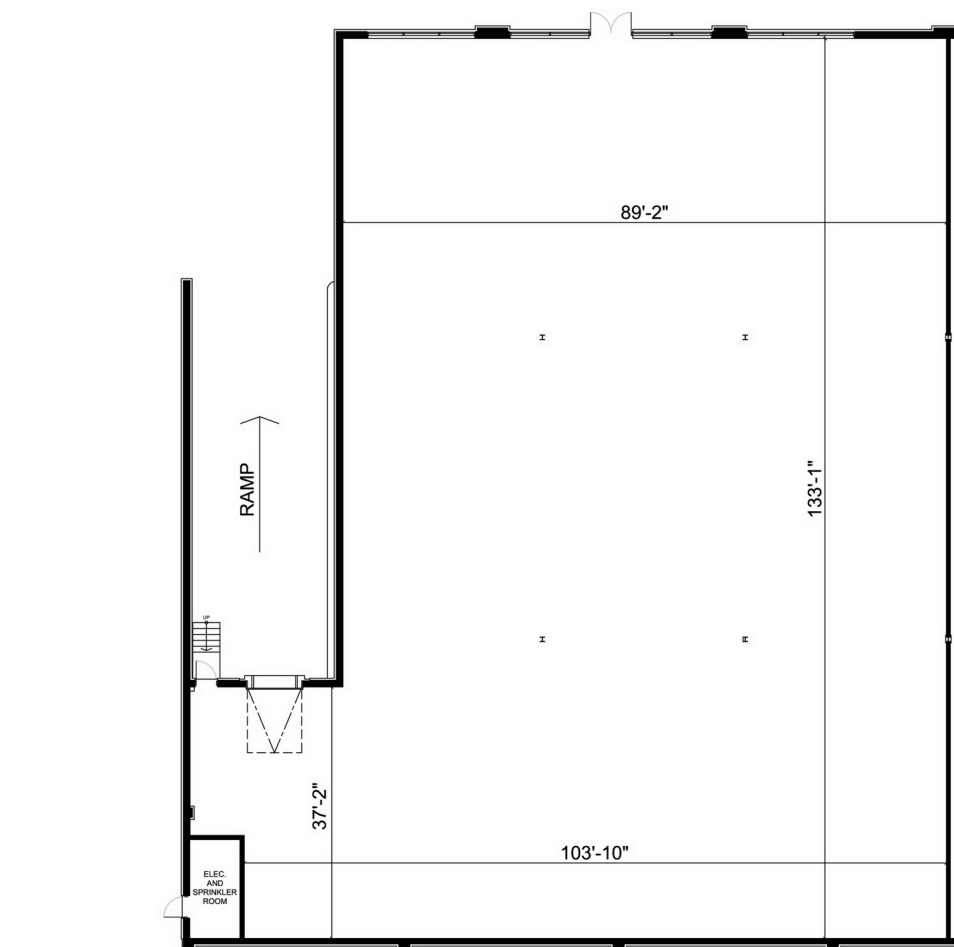

UNIT 2  
RENTABLE AREA = 13,129 SF  
RENTABLE AREA PROVIDED BY METRUS

LOCATION:

**18183 Yonge Street**  
**Town of East Gwillimbury**

South-east corner of Yonge St. & Green Lane



FOR MORE INFORMATION, PLEASE CONTACT:

**Antoinette Grossi**  
Director of Leasing

**905.669.9714**  
[agrossi@metrusproperties.com](mailto:agrossi@metrusproperties.com)

The information combined herein has been obtained from source deemed reliable; however, we do not warrant its accuracy. The information herein may change from time to time without notice. The property may be withdrawn from the market without notice.