

# CITY PROFILE

## TOWN OF HALTON HILLS

### Regional Municipality of Halton

- Located in the Halton Hills 401-407 Gateway Business Park.
- Halton Hills offers competitive tax rates.
- Offers high quality build-to-suit developments in strategic locations at attractive prices.
- Highways 401 and 407 provide quick access to the Greater Toronto Area (GTA) and beyond.
- Close proximity to Toronto Pearson Airport.
- Halton Hills has a highly educated and diversified labour force.
- Area has attracted top Industrial and Office firms.

# PROJECT PROFILE

## HALTON HILLS CENTRE

Town of Halton Hills, Regional Municipality of Halton

**LOCATION:**

West of Ninth Line on the south side of Steeles Ave.

**PLAN NUMBER:**

20R16374

**LOT 1:**

14920 Steeles Ave West.

**ACREAGE:**

31.34 Acres

**LEGAL DESCRIPTION:**

Part of the West Half of Lot 15, Concession 9  
Designated as Part I

**ZONING**

Prestige Industrial  
H (M-1)

**ACREAGE:**

21.21 Acres

**SITE ATTRACTIONS:**

- Highway 401 exposure
- Toronto International Airport
- Highway 407 exposure

**LOT 2:**

15216 Steeles Ave East

**LEGAL DESCRIPTION:**

Part of the East Half of Lot 15, Concession 9  
Designated as Part I

# HALTON HILLS CENTRE

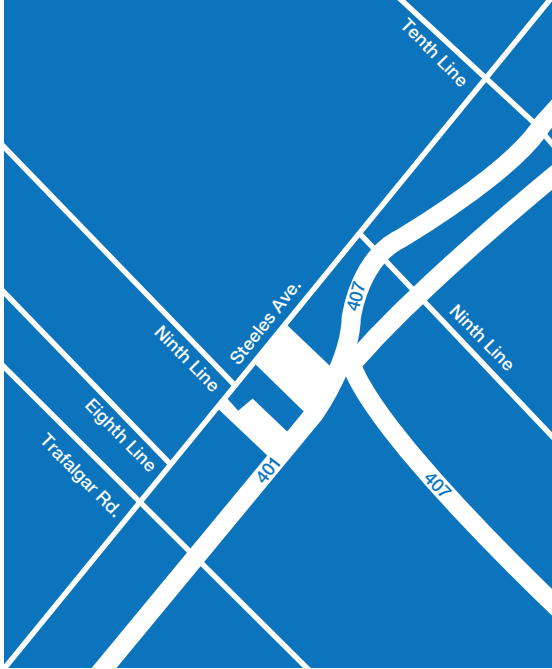
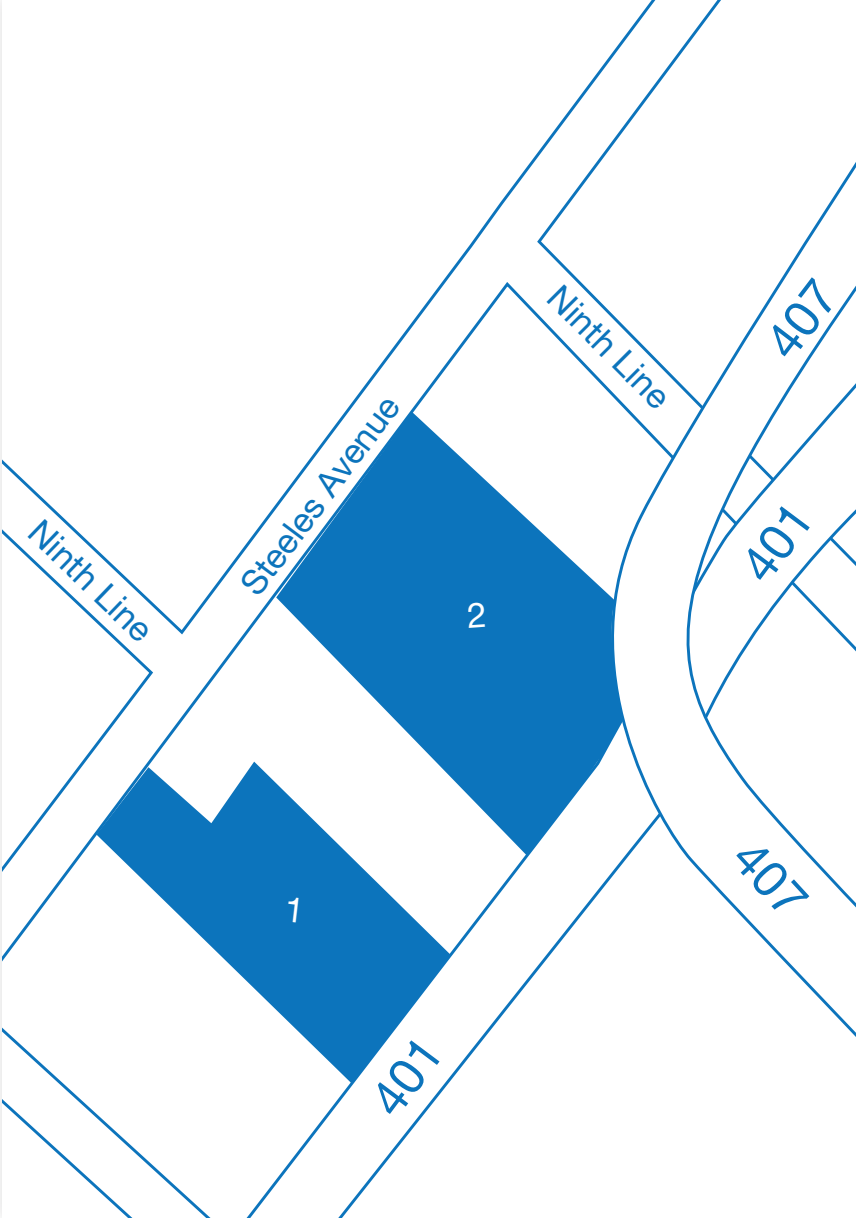

**HALTON HILLS CENTRE:**

LOT	ACREAGE	ZONING
1	21.21	H (M-1)
2	31.34	H (M-1)